

Prelude: *Melancholy of the Future*

Hoe op de toekomst te anticiperen aan het einde van een enorm uitdagend jaar?

De kunstwerken in deze tentoonstelling gaan in op ideeën van verwachting, retrospectie en verlangen, en suggereren alternatieven voor de stapsgewijze openvolging van begin, midden en einde.

De drie tentoonstellingsruimtes van het museum worden elk door een citaat uitgelicht dat de rigiditeit van dit driedelige schema in twijfel trekt.

Als benefiettentoonstelling zijn alle werken in *Prelude: Melancholy of the Future* te koop. De opbrengsten helpen MDD, de deelnemende kunstenaars, en in veel gevallen hun galerieën, door deze onzekere tijden heen te komen.

Prelude: Melancholy of the Future is de laatste tentoonstelling vóórdat MDD tot het najaar 2021 sluit voor renovatie. Blijf op de hoogte van de komende online en off-site projecten via onze website, instagram en facebook.

How to anticipate the future at the end of an immensely challenging year?

The artworks in this exhibition play on ideas of anticipation, retrospection and longing, suggesting alternatives to the progressist logic of beginning, middle and end.

Each of MDD's main spaces is identified by a quote, which questions the fixity of this three-fold scheme.

As a charity exhibition, all the works in *Prelude: Melancholy of the Future* are for sale. The proceeds will help MDD, the participating artists, and in many cases their galleries, make it through the uncertain times ahead.

Prelude: Melancholy of the Future is the last exhibition before MDD closes for renovations until late 2021. In the meantime, stay up to date with MDD's forthcoming online and off-site projects via our website, instagram, and facebook.

Voor meer informatie over prijzen kunt u terecht bij de receptie of kunt u contact opnemen met Monique.Famaey@museumdd.be

For more information about prices please ask at the reception or contact Monique.Famaey@museumdd.be

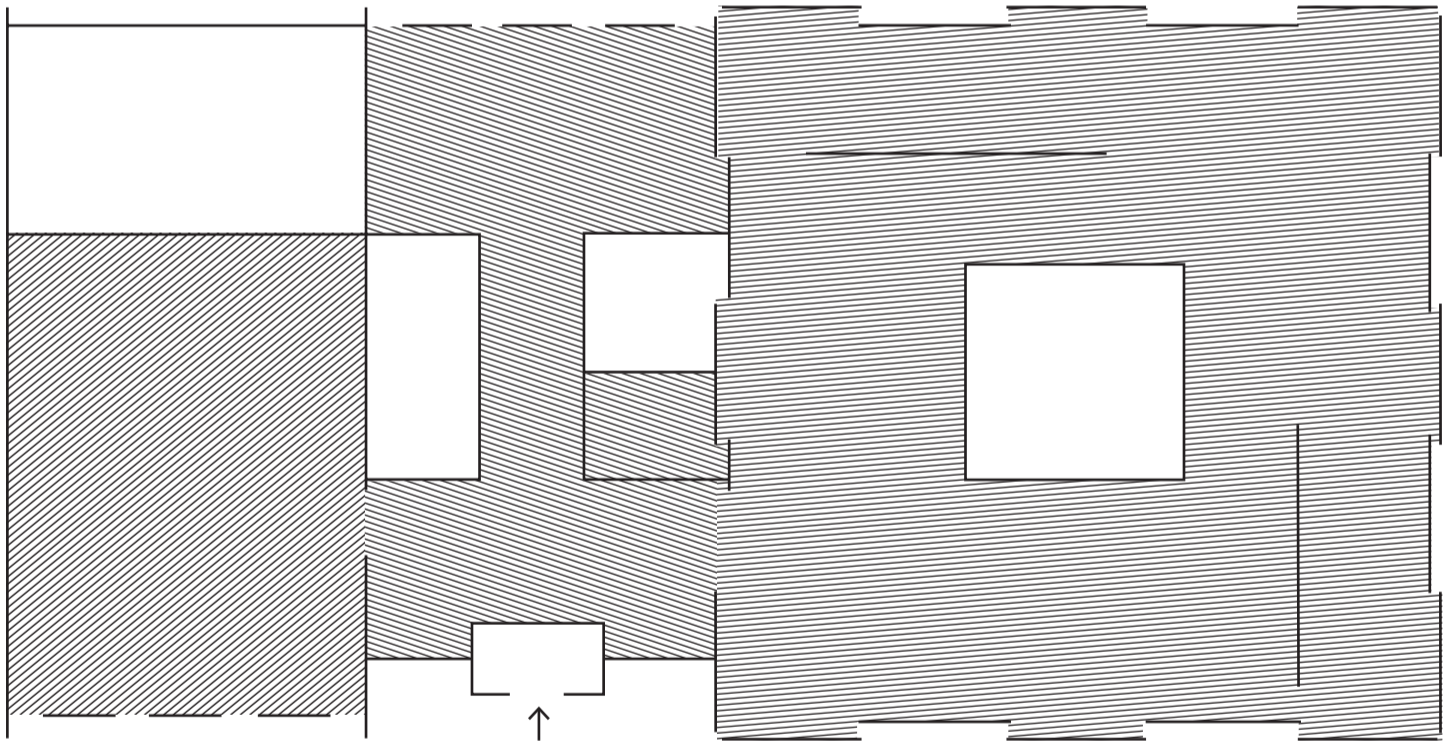

"Let's massage history"

Sonic Youth, *Massage the History. On: The Eternal*, 2009.

"Stop building cathedrals and pyramids which are doomed to fall into ruin. Live in the present; live once more in Time and by Time - for a wonderful and absolute reality."

Jean Tinguely, *Für Statik (Manifesto for Statics)*, 1959.

"... when you look forward you shall see a long forever, a boundless duration before you, which will swallow up your thoughts."

Jonathan Edwards (1741), as quoted by Robert Smithson, "Letter to the Editor," *Artforum*, 1967.

Prelude: Melancholy of the Future
Museum Dhondt-Dhaenens
nov. - dec. 2020

Artists: Ida Barbarigo, Meriem Bennani, Pierre Bismuth, Katinka Bock, Manon de Boer, Lucia Bru, Michael Dean, Edith Dekyndt, Kasper De Vos, Lieve D'hondt, David Douard, Jerónimo Elespe, Luca Frei, Ryan Gander, Anna Bella Geiger, Thomas Hirschhorn, Gary Hume, Patricia Leite, Jonathan Meese, Bjarne Melgaard, Philip Metten, Yuko Nasaka, Antonio Obá, Hans Op de Beeck, Shahpour Pouyan, Laure Prouvost, Tal R, Magali Reus, Giangiacomo Rossetti, Chris Huen Sin Kan, David Tremlett, Rinus Van de Velde, Paul Van Hoeydonck, Atelier Van Lieshout, Richard Venlet.

curatoren / curators: Antony Hudek, Laurens Otto

scenografie / scenography: Richard Venlet

development: Monique Famaey

communicatie / communication: Rik Vannevel

grafisch ontwerp / graphic design: Jef Cuypers & Chloé D'hauwe

logistiek / logistics: Jan(us) Boudewijns

installatie / installation: An-Valerie Vandromme

met de steun van / assisted by: Arne Bastien, Merel Cremers, Lore Dejonckheere, Thomas Filliers, Tato Greve, Els Jacobs, Vincent Laute, Jimmy Soetaert, Bernard T'Hoof, Michiel Van Damme

financiële coördinatie / financial coordination: Kelly De Cock, Nathalie De Pauw

publiekswerking / public outreach: Beatrice Peceeu, Linde Vannevel

met dank aan galeriën / with thanks to galleries: The approach, Galerie Jean Broly, CLEARING, Galerie Chantal Crousel, KETLEER GALLERY, LABOR, Tim Van Laere Gallery, Simon Lee Gallery, Sprüth Magers, Maisterravalbuena, Galerie Greta Meert, Mendes Wood DM, Jan Mot, Galerie Nathalie Obadia, Esther Schipper, Axel Vervoordt, Van Doren Waxter Gallery, Galerie Barbara Wien, Zeno X Gallery.

bijzondere dank aan / with special thanks to: Sander Bortier, Francis Carpentier, Chantal Crousel, Stephanie Donck, Carolyn Drake, Patricia Duyck, Philippe Hanet, Katrien Van Hulle, Pauline Haon, Eric Hemeleers, Arienne Kamsteeg, Ann Maroelis, Arne Notebaert, Henk Somers, Rirkrit Tiravanija, Lieselot Vandecapelle, Peter van der Graaf, Benedikt van der Vorst, Arne Van Wouterghem, Hendrik Vermeire, Boris Vervoordt, Jeroen Wille.

Prelude: Melancholy of the Future genoot van de genereuze steun van / *Prelude: Melancholy of the Future* benefited from the generous support of:

CHRISTIE'S

distriplex®

EECKMAN art & insurance

eland

LE

LIMITED EDITION Fashion for Floors

atec2 high tech flooring

HANDLED BY WWW.AORTA.BE

axel vervoordt gallery

axel vervoordt gallery

axel vervoordt gallery

axel vervoordt gallery

axel vervoordt gallery

axel vervoordt gallery

“Let’s massage history”

- Luca Frei, *Everything Was To Be Done. All The Adventures Are Still There*, 2003-2020
Digital print on vinyl mesh, eyelets, 230 x 150 cm
Courtesy of the artist
- Ida Barbarigo, *Untitled (Self Portrait)*, s.d. circa 1993
Tempera on paper, mounted on cardboard, 46 x 32,5 cm
Courtesy of Axel Vervoordt Gallery and BCM Archive
- Michael Dean, *Lo! (Working Title)*, 2017
Concrete, scene tape (tender tender), cable ties and ink, stained publication (Ilo Vey), 212 x 98 x 59 cm
Courtesy of the artist and Mendes Wood DM
- Ryan Gander, *Logic murders magic (Eighty-eighth page)*, 2020
A pencil drawing found on page 88 of the artist’s sketch book, framed and cast in graphite, 55 x 42 x 6 cm
Courtesy of the artist and Esther Schipper
- Michael Dean, *Analogue Series (Bruise Petals)*, 2017
Ink soaked paperback publication, 24,15 x 23 x 27 cm
Courtesy of the artist and Mendes Wood DM
- Richard Venlet, *Firewood*, 2015
Edition 4/6, 4 Plastic bags with sawn original wooden Loge doors from Victor Horta’s Henry LeBoeuf hall, 1928, Vinyl drawing of the door scale 1/1, 217 x 68 cm
Courtesy of the artist and BOZAR
- Giangiaco Rossetti, *Group F, Bones of the Men*, 2019
Six bronze sculptures, edition of 3 + 1 AP, dimensions variable
Courtesy of the artist and Mendes Wood DM
- Magali Reus, *Sentinel (Vapor Trail)*, 2018
Sprayed fiberglass and polyester resin, pigments, air brushed aluminium, embroidered custom weave viscose, polyester and cotton, sand cast bronze, laser engraved leather, cotton twine, powder coated aluminium and steel, dome nuts, variable dimensions
Courtesy of the artist and The approach
- Magali Reus, *Settings (Twice Pacific)*, 2019
Powder coated and airbrushed steel, aluminium, sprayed UV printed resin, acrylic, grub screws, 71 x 71 x 5 cm
Courtesy of the artist and The approach
- Atelier Van Lieshout, *Pipe Bomb Clock Lamp*, 2019
Steel, 180 x 21 x 21 cm
Courtesy of the artist
- Patricia Leite, *Sé*, 2019
Oil on wood, 110 x 90 cm
Courtesy of the artist and Mendes Wood DM
- Jonathan Meese, *TIER III (AUFNAHME)*, 2019
Acrylic on canvas, 210 x 281 x 3,3 cm
Courtesy of the artist and Tim Van Laere Gallery
- Anna Bella Geiger, *OHREN ATHENA COM ORBIS DESCRIPTIO*, from the series *Fronteiricos*, 2017
Vintage iron file drawer, chrome object, cobalt blue and gold pigment, 15 x 32,5 x 13 cm
Courtesy of the artist and Mendes Wood DM
- Richard Venlet, *Salon*, 2020
18 Plexiglass panels, dimensions variable
Courtesy of the artist
- Richard Venlet, *MDD Carpet*, 2020
In situ installation – Carpet on museum floor, dimensions variable
Courtesy of the artist

“ Stop building cathedrals and pyramids which are doomed to fall into ruin. Live in the present; live once more in Time and by Time – for a wonderful and absolute reality.”

- David Tremlett, *Surface Construction #8 (Mexico)*, 2010
Pastel on paper, 61 x 62 cm
Courtesy of the artist and Galerie Jean Brolly
- Chris Huen Sin Kan, *Doodood*, 2020
Watercolour and coloured pencil on paper, 29,7 x 42 cm
Courtesy of the artist and Simon Lee Gallery
- Rinus Van de Velde, *Every night when I made my entrance...*, 2018
Charcoal on canvas, artist frame, 300 x 360 cm
Courtesy of the artist and Tim Van Laere Gallery
- Chris Huen Sin Kan, *Tess and Joel*, 2020
Watercolour and coloured pencil on paper, 29,7 x 42 cm
Courtesy of the artist and Simon Lee Gallery
- Thomas Hirschhorn, *Spinoza Car*, 2009
Car (Volvo), cardboard, books, glasses, transparent colour paper, handwritten paper, paper print, transparent tape, colour tape, wire, heart plush, 190 x 235 x 425 cm
Courtesy of the artist and Galerie Chantal Crousel
- Hans Op de Beeck, *Blossom Tree (8)*, 2019
Steel, concrete, polyurethane, polyester, epoxy resin, coating, plywood, 254 x 120 x 97 cm
Courtesy of the artist
- Giangiaco Rossetti, *Untitled*, 2019
Pastel and pencil on paper, 52 x 45 cm
Courtesy of the artist and Mendes Wood DM
- Jerónimo Elespe, *Named*, 2019-2020
Oil on aluminium panel, 38 x 25 cm
Courtesy of the artist and Van Doren Waxter, LABOR, and Maisterravalbuena
- Luca Frei, *Supports for sitting, standing, leaning and dancing*, 2019-2020
6 of 14 elements in MDF upholstered in new wool, rubber feet, each ca. 45 x 75 x 45 cm
Courtesy of the artist and Galerie Barbara Wien
- Yuko Nasaka, *Untitled*, 2015
Plaster and pigment on wooden panel, 46 x 136 cm
Courtesy the artist and Axel Vervoordt Gallery

“ ... when you look forward, you shall see a long forever, a boundless duration before you, which will swallow up your thoughts.”

- David Douard, *MO! S’SPITTER AND DRIBBLE*, 2014
Silkscreen on T-Shirt, plastic, wood, eggs, 114,5 x 80 x 11 cm
Courtesy of the artist and Galerie Chantal Crousel
- Philip Metten, *11033-01B*, 2020
Collage on paper, polystyrene, 41,6 x 45,0 x 3,2 cm
Courtesy of the artist and Zeno X Gallery
- Meriem Bennani, *Neighborhood Goggles*, 2019
Aluminium, steel, stainless steel, rocks, rubber coating, automotive paint and high definition video, colour, sound, 3 min 2 sec, 194,3 x 144 x 144 cm each
Courtesy of the artist and C L E A R I N G
- Magali Reus, *Settings (Antennae)*, 2019
Powder coated and airbrushed steel, CNC’d aluminium, aluminium hex pole, hex bolts, sprayed UV printed resin, acrylic, grub screws, 71 x 71 x 5 cm
Courtesy of the artist and The approach
- Manon de Boer, *Maud Capturing the Light on a Clear Day*, 2015
16mm film
Courtesy of the artist and Jan Mot
- Gary Hume, *Life Jacket*, 2018
Gloss on paper, 107 x 75,5 cm
Courtesy of the artist and Sprüth Magers
- Lieve D’hondt, *Beyond Lines*, 2020
Print on plexiglass, 109 x 80 cm
Courtesy of the artist
- Antonio Obá, *Variações especulares – Narciso*, from the series *Ambiente com Espelhos*, 2017
Antique wood frame and brushed steel, 179 x 103,5 x 4 cm
Courtesy of the artist and Mendes Wood DM
- Pierre Bismuth, *En suivant la main gauche de Jacques Lacan – La sexualité*, 2010
Inkjet print on paper, 69 x 93,5 cm
Courtesy of the artist and Jan Mot
- Laure Prouvost, *Narrative Painting, You Are Swallowing Air, Did You Know That*, 2020
Oil, collage, and aquarel on paper, 45 x 30 cm
Courtesy of the artist and Galerie Nathalie Obadia
- Atelier Van Lieshout, *Funnelhead (block)*, 2012
Bronze, edition of 3 + 1 AP, 44 x 48 x 38 cm
Courtesy of the artist
- Edith Dekyndt, *Untitled*, 2016
Fabric, copper leaves, various dimensions
Courtesy of the artist and Galerie Greta Meert
- Bjarne Melgaard, *Untitled*, 2020
Oil on canvas, 200 x 200 cm
Courtesy of the artist and KETELEER GALLERY
- Ida Barbarigo, *Untitled*, from the series *Son cose che incantano (Spellbinding)*, 1976
Oil on canvas, 65 x 99 cm
Courtesy of Axel Vervoordt Gallery and BCM Archive
- Katinka Bock, *Palomar*, 2020
Ceramic, 62 x 29 x 13,5 cm
Courtesy of the artist and Galerie Greta Meert
- Hans Op de Beeck, *Brian*, 2018
Polyester, glass, coating, edition 1 of 5 + 2 AP, 62 x 58 x 62 cm
Courtesy of the artist
- Atelier Van Lieshout, *Scout with Hood, Knife and Skull*, 2020
Mixed media, 200 x 90 x 50 cm
Courtesy of the artist
- Paul Van Hoeydonck, *To Open the Way to the Stars*, 2020
Mixed media relief, 94 x 122 x 10 cm
Courtesy of the artist
- Kasper De Vos, *Groei Mal*, 2020
Plastered cast, bister pigment, Styrofoam plate, blue transport pallet, wooden support, rubber stretch, various dimensions
Courtesy of the artist
- Tal R, *August*, 2019-2020
Oil on canvas, 294 x 200 cm
Courtesy of the artist and Tim Van Laere Gallery
- Gary Hume, *Peace Park*, 2020
Enamel on galvanized steel, 590 x 500 x 300 cm
Courtesy of the artist and Sprüth Magers
- Atelier Van Lieshout, *Crucifix*, 2020
Fiberglass, 400 x 250 x 312 cm
Courtesy of the artist
- Lucia Bru, (*aérocubes*), 2017
Paper and rough porcelain, 199 x 188 x 211 cm
Courtesy the artist and Axel Vervoordt Gallery
- Philip Metten, *C-086*, 2017
Collage on paper, 33,9 x 33,5 cm
Courtesy of the artist and Zeno X Gallery
- Philip Metten, *C-094*, 2017
Collage on paper, 42,6 x 40,3 cm
Courtesy of the artist and Zeno X Gallery
- Shahpour Pouyan, *My place is the placeless – Untitled*, 2017
Glazed stoneware ceramic, 7 x 23 cm
Courtesy of the artist and Galerie Nathalie Obadia
- Shahpour Pouyan, *My place is the placeless – Untitled*, 2017
Glazed stoneware ceramic, 22 x 23 cm
Courtesy of the artist and Galerie Nathalie Obadia
- Shahpour Pouyan, *My place is the placeless – Untitled*, 2017
Glazed stoneware ceramic, 25 x 24 cm
Courtesy of the artist and Galerie Nathalie Obadia
- Richard Venlet, *MDD Carpet*, 2020
In situ installation – Carpet on museum floor, dimensions variable
Courtesy of the artist